

BD[®] Nexiva[™]

Closed IV Catheter System—Single Port with BD[®] MaxZero[™] Needle-free Connector

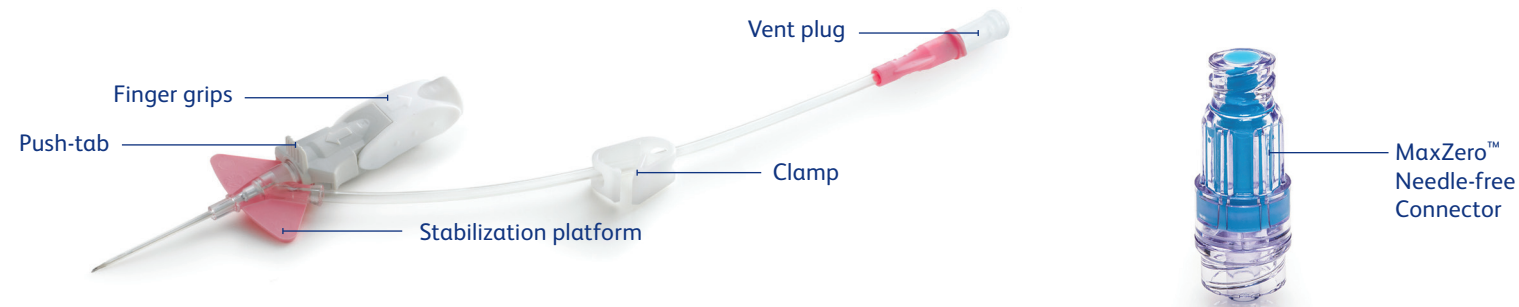

Scan this code to watch a video on how to use the Nexiva[™] Closed IV Catheter System ▶



Points to practice

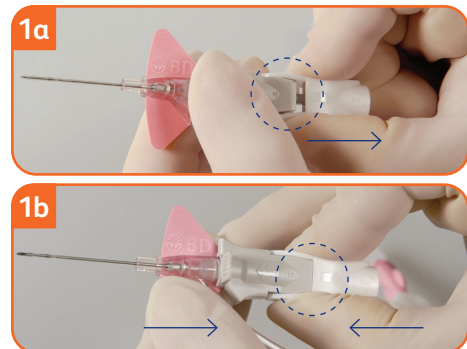

Preparation

- Secure vent plug.
- Clamp should not be engaged.
- Twist to remove needle cover.
- Holding as shown, pull back approximately 1/8 in. on finger grips (Fig. 1a).
- Push finger grips back to their original position so the stabilization platform and finger grips are snugly together (Fig. 1b).

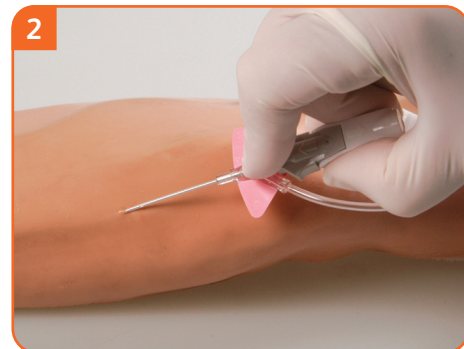

Insertion and flashback

- Hold the system as shown and access the vessel (Fig. 2).
- Observe blood return along the catheter. Decrease angle of insertion and advance needle unit slightly to ensure catheter tip is within the vessel.

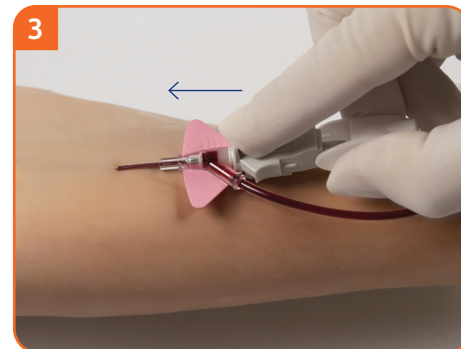

Advancement

- Place pad of index finger behind the push-tab and push the catheter off the needle into the vessel (Fig. 3).
- Note: Do not pull back on the needle during advancement.*



Needle removal

- Stabilize the catheter system, and pull back on the finger grips until the push-tab component releases from the stabilization platform (Fig. 4).
 - Discard the shielded needle into a puncture-resistant, leak-proof sharps container.
- Note: Do not hold the push-tab component of the device as this will prevent the release of the needle shield.*

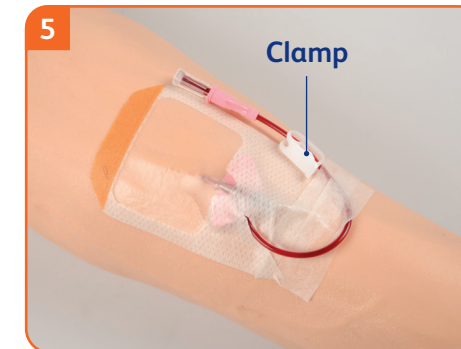

Stabilization

- Apply a transparent dressing to cover the septum, allowing maximum use of extension tubing (Fig. 5).



Preparation for use

- Engage the clamp.
- Prime the MaxZero[™] Needle-free Connector according to your facility policy.
- Remove the vent plug and attach the MaxZero[™] Needle-free Connector (Fig. 6).
- Disinfect the MaxZero[™] Needle-free Connector with an appropriate antiseptic and allow to dry.
- Attach the flush syringe or administration set.
- Release the clamp to flush or infuse.
- When disconnecting a luer lock syringe or tubing set from the MaxZero[™] Needle-free Connector, carefully rotate the luer 360-degrees counter clockwise and turn using a controlled motion to minimize fluid escaping.

Consult product insert for complete instructions, warnings and cautions.

BD, Sandy, UT, 84070, U.S.

bd.com

